

How to install your ecobee room sensor

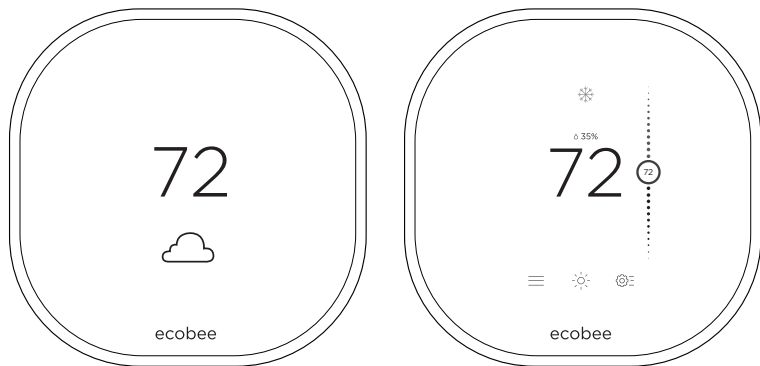

STEP 1: PAIRING

To set up your room sensor, ensure that your ecobee is awake by either standing in front of it or touching the screen.



STEP 2: PAIRING

Pull the plastic tab on your room sensor and it will power connect to your ecobee automatically.

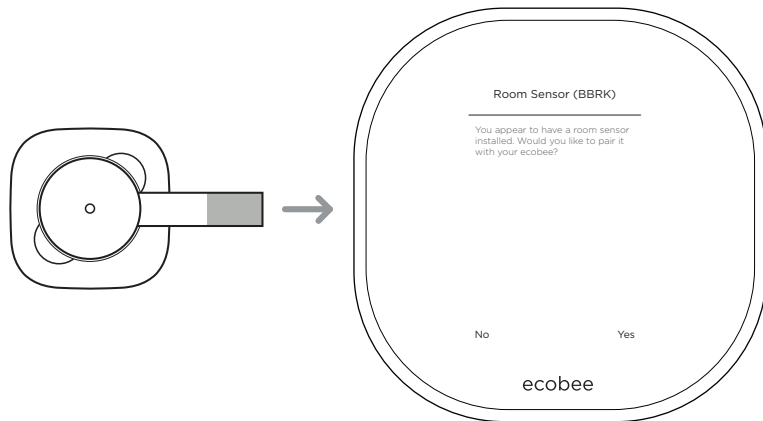

STEP 3: PAIRING

Continue to finish your sensor set-up.



STEP 1: PLACEMENT

There are two ways that you can place the sensor: mount it on a wall or place it on a flat surface.

OPTION 1: WALL

Attach using the screw provided.

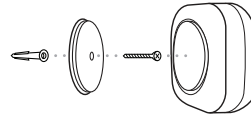

OPTION 2: FLAT SURFACE

Attach the stand by removing the smaller back cover and popping the stand into place.

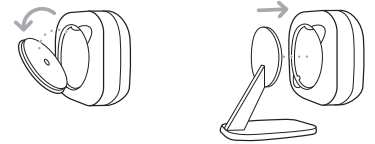

To remove the stand, pull the base outwards.

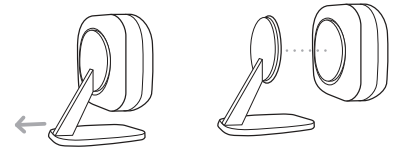

STEP 2: PLACEMENT

If you are placing your room sensor on a wall:

Place it at a height of approximately 5ft / 1.5m on an interior wall.
Place away from direct heat/cool sources, such as a fireplace or air vent.

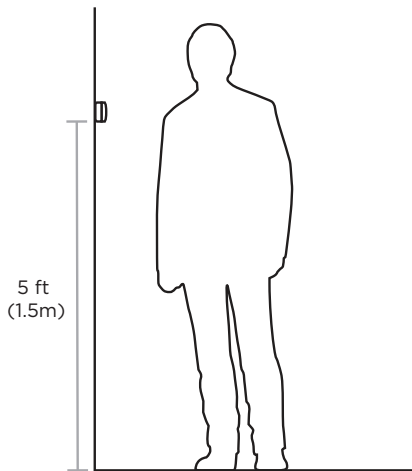



STEP 3: PLACEMENT

If you are placing your room sensor on a flat surface:

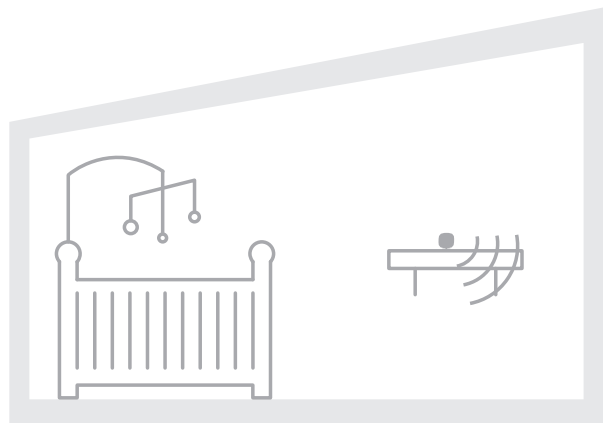
Place on a flat surface using the stand provided.
Make sure it is facing the room, instead of the wall



 **TIP** The bee should always be facing upwards.

 **TIP** The bee should always be facing upwards.

TROUBLESHOOTING

If your sensor does not pair with your ecobee:

1. Remove the battery.
2. Wait 2 minutes.
3. Re-insert the battery to restart the detection process.



NOTE To access the battery, pop the room sensor back cover off using the ridges provided.

TROUBLESHOOTING

If your thermostat is showing “N/A”:

Your sensor is out of range. Try moving it closer to the thermostat. When in range, they will connect automatically.

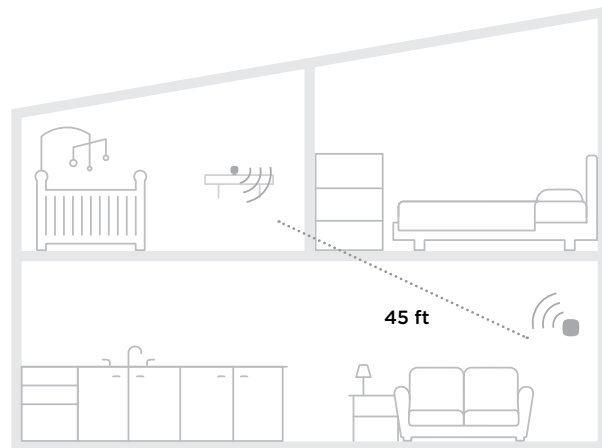

Room Sensor Specifications

Model No:	EBRSE4-01
FCC ID:	WR9EBRSE4
IC:	7981A-EBRSE4
Dimensions:	44x44x20 mm without the stand. 53 mm tall when mounted on the stand
Wireless band:	915 MHz
Power source:	CR2032 watch battery
Operating conditions:	Operating Temperature: 0°C to 40°C
Operating Humidity:	20% to 80% RH

FCC Compliance Statement

Compliance Notice:

This equipment has been tested and found to comply with the limits for a Class B digital device, pursuant to part 15 of the FCC Rules. These limits are designed to provide reasonable protection against harmful interference in a residential installation. This equipment generates, uses and can radiate radio frequency energy and, if not installed and used in accordance with the instructions, may cause harmful interference to radio communications. However, there is no guarantee that interference will not occur in a particular installation. If this equipment does cause harmful interference to radio or television reception, which can be determined by turning the equipment off and on, the user is encouraged to try to correct the interference by one or more of the following measures:

- Reorient or relocate the receiving antenna.
- Increase the separation between the equipment and receiver.
- Connect the equipment into an outlet on a circuit different from that to which the receiver is connected.
- Consult the dealer or an experienced radio/TV technician for help.

This device complies with part 15 of FCC rules. Operation is subject to the following two conditions:

1. This device may not cause harmful interference.
2. This device must accept any interference received, including interference that may cause undesired operation.

Change or modifications that are not expressly approved by the manufacturer could void the user's authority to operate the equipment.

RF Exposure Information:

This equipment complies with FCC radiation exposure limits set forth for an uncontrolled environment. In order to avoid the possibility of exceeding the FCC radio frequency exposure limits, human proximity to the antenna shall not be less than 20cm during normal operation.

Industry Canada (IC)

Compliance Notice:

This device complies with Industry Canada license-exempt RSS standard(s).

Operation is subject to the following two conditions:

1. This device may not cause interference, and
2. This device must accept any interference, including interference that may cause undesired operation of the device.

This Class B digital apparatus complies with Canadian ICES-003.

RF Exposure Statement:

This equipment complies with IC RSS-102 radiation exposure limits set forth for an uncontrolled environment. This transmitter must be installed to provide a separation distance of at least

20 cm from all persons and must not be collocated or operating in conjunction with any other antenna or transmitter.

Warning: Changes or modifications not expressly approved by ecobee Inc. could void the user's authority to operate the equipment.



We're here to help.

ecobee.com

support@ecobee.com

1.877.932.6233

© 2016 ecobee, Inc. All rights reserved. ecobee and the ecobee logo are trademarks of ecobee Inc., registered in the U.S. and other countries.

EB-RSE3PK2-01



770-00045